

Mental Health: MA

The Department of Family Relations and Applied Nutrition is introducing an innovative degree to provide unique opportunities and increase flexible pathways to learning about mental health.

The Master of Arts in Mental Health (MA.MH) program will provide graduates with learning that they may apply to an existing or future career path in community-based human service organizations.

uoguelph.ca/gradprograms/ma-mh

PROGRAM

The MA.MH program is designed to give students the best non-clinical mental health training possible in Ontario.

It is intended for those seeking to upgrade their education and/or enhance mental health knowledge, as this degree is infused with systemic thinking and Equity, Diversity, and Inclusion (EDI) considerations.

This unique program is designed to have 9 remote synchronous academic courses that can be completed in as little as three semesters. The remote synchronous delivery allows for great flexibility to working individuals.

Students may apply in any semester as we will be holding rolling admissions for this program.

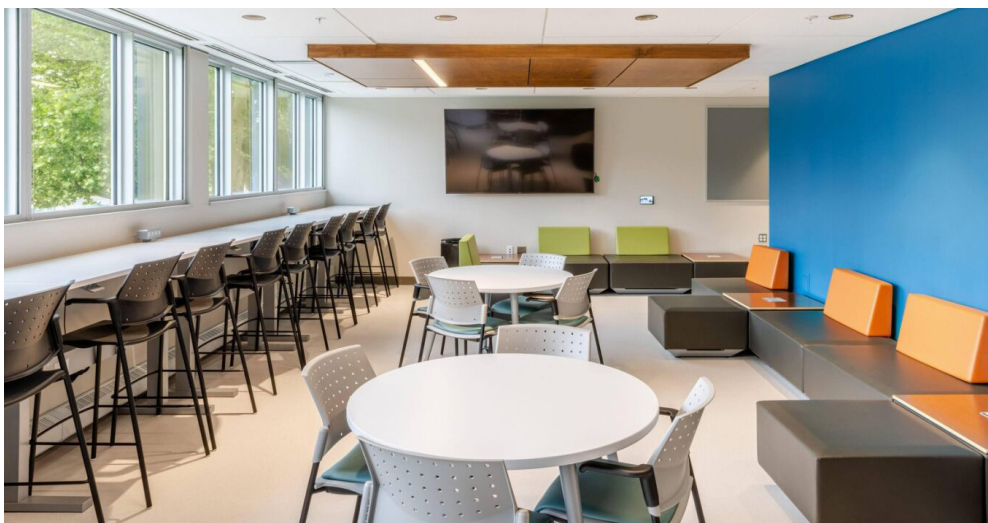

ADMISSION REQUIREMENTS

Admission to the MA.MH program requires:

- honours (4-year) baccalaureate degree, with a minimum 75% average in the last two years of study
- minimum 70% average in a social science research methods course
- letter of interest
- two academic references
- transcripts

Currently regulated health professionals practicing psychotherapy or a related field are welcome to apply.

Application Deadline:

[See website for dates](#)

Entry: Fall

ARE YOU INTERESTED IN:

- mental health
- influencing social policy
- enhancing current career

THIS PROGRAM IS WELL SUITED FOR:

- teachers and guidance counsellors
- human resource professionals
- emergency service providers
- allied health professionals

CONTACT INFORMATION

Graduate Program Assistant:

Shauna Porter
519-824-4120 x53968
rptp@uoguelph.ca